

Pneumatic rock drills – BBC/BBD/RH

High quality. Long lifetime. Low long-term costs.



Atlas Copco

Real value

As soon as you pick it up, you'll feel the quality. It's solid, well made. Start it up and you'll notice the raw power.

But to appreciate the real advantages of an Atlas Copco rock drill, you'll have to wait. Each and every part is made to the highest tolerances and of the very best materials. This means that even when you replace a part, your drill will deliver the same performance as when it was new. Time after time. Year after year.

How long does an Atlas Copco rock drill last? Let's just say that by the end of its service life you'll be in no doubt that it's given you real value for money.

High quality for high performance

But our drills are not just a good long-term investment, they also make money from day one. This is because Atlas Copco rock drills are efficient. For every litre of air you put in, you'll get high impact energy out.

Why? Again, the answer is quality. And quality is no accident. It's a question of using the right materials, proven heat treatment methods and machining to high tolerances. Last but not least, quality is the result of good honest engineering: today's range is based on the same reliable design as the Atlas Copco drills that launched the Swedish Method back in the 1940s.

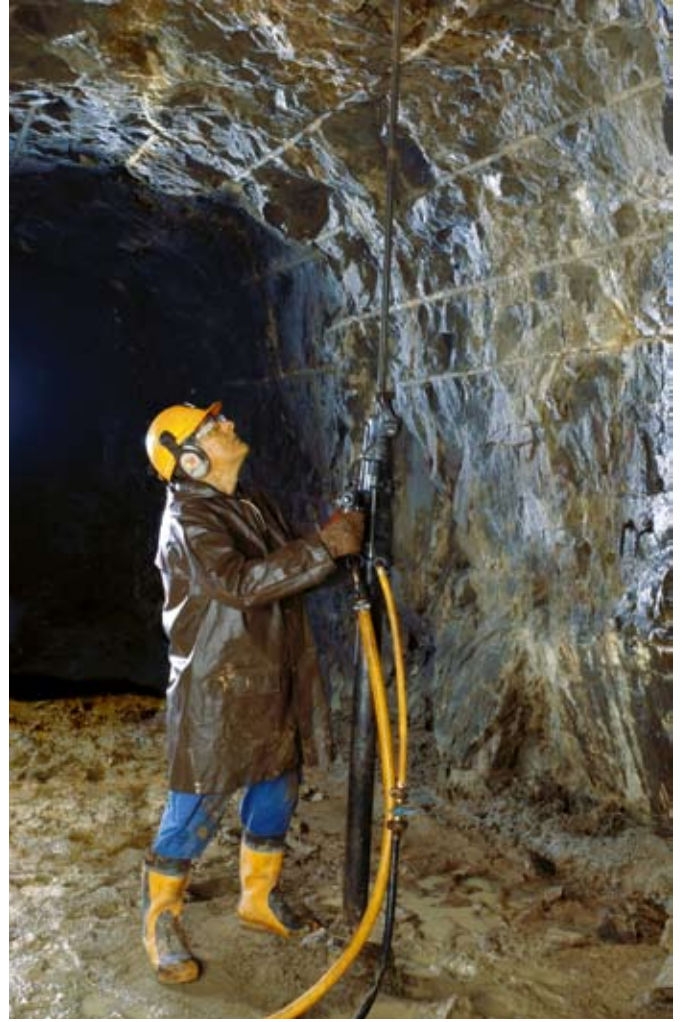

Stoper

BBD 46WS/WR – Falcon

- Suitable for production drilling, raise driving and bolting in soft to medium hard rock
- Short stroke, good penetration rates
- Large piston diameter gives high efficiency even at low air pressure
- Ratchet wheel rotation mechanism
- WR version with clockwise rotation for tightening nuts and roof bolting

Stoper data

Type	Part No	Hole range	Air consumption at 6 bar	Rock drill Piston bore	Stroke length	Impact rate at 6 bar	Feed Piston bore	Feeding length	Length retracted	Length extracted	Weight
		<i>mm</i>	<i>l/s</i>	<i>mm</i>	<i>mm</i>	<i>Hz</i>	<i>mm</i>	<i>mm</i>	<i>mm</i>	<i>mm</i>	<i>kg</i>
BBD 46WS-6	8311 0202 03	27-41	75	75	45	51	75	770	1435	2205	39
BBD 46WS-8	8311 0202 11	27-41	75	75	45	51	75	970	1650	2620	40
BBD 46WR-6	8311 0202 29	27-41	75	75	45	49	75	770	1435	2205	39
BBD 46WR-8	8311 0202 37	27-41	75	75	45	49	75	970	1650	2620	40

Find the right drill



BBC 16W – Puma

- All-round rock drill, suitable for most drilling applications in medium to hard rock
- Long stroke, good penetration rate
- Robust rifle bar rotation mechanism
- Pusher leg control placed in back head of the rock drill



BBC 34W – Leopard

- Highly efficient in medium to hard rock
- Long stroke, high impact energy
- Large piston diameter makes it very efficient even at low air pressure
- Powerful rifle bar rotation mechanism
- Pusher leg control placed in back head of the rock drill



BBD 94W – Panther

- High performance rock drill for soft to hard rock
- Short stroke and high impact rate makes it ideal for soft rock
- Large piston diameter for high efficiency even at low air pressure
- Ratchet wheel rotation mechanism
- Pusher leg control is placed on the pusher leg



RH 656W

- Suitable for soft to medium hard rock
- Good ratio between high penetration/low air consumption
- Due to low weight, it can also be used as a sinker. Supplied with T-handle
- Robust rifle bar rotation mechanism
- Pusher leg control is placed on the pusher leg

Rock drill data

Type	Part No	Hole range	Air consumption at 6 bar	Piston bore	Stroke length	Impact rate at 6 bar	Length	Weight
		<i>mm</i>	<i>l/s</i>	<i>mm</i>	<i>mm</i>	<i>Hz</i>	<i>mm</i>	<i>kg</i>
BBC 16W	8311 0401 10	27-41	69	70	55	39	710	26
BBC 34W	8311 0408 05	27-41	88	80	70	38	775	31
BBD 94W	8311 0206 09	27-41	97	90	45	55	670	27
RH 656W	8311 0303 45	27-41	48	65	60	34	630	22

Pusher leg data

Type	Part No	Suitable for rock drill	Piston bore	Feeding length	Length retracted	Length extracted	Weight
Single telescope			<i>mm</i>	<i>mm</i>	<i>mm</i>	<i>mm</i>	<i>kg</i>
BMT 51	8321 0301 01	BBC 16W, 34W	60	1300	1658	2958	15
ALF 71	8321 0201 94	BBC 16W, 34W	70	1300	1805	3105	14
ALF 71-1	8321 0201 95	BBC 16W, 34W	70	950	1455	2405	13
ALF 72D	8321 0201 80	BBD 94W	70	1300	1970	3270	19
ALF 72D-1	8321 0201 81	BBD 94W	70	1200	1830	3030	16
BMK 62S	8321 0102 02	RH 656W	53	1300	1815	3115	17
Double telescope							
ALF 67/80	8321 0201 85	BBC 16W, 34W	67/80	1855	1495	3350	17
ALF 67/80D	8321 0201 69	BBD 94	67/80	1855	1595	3450	19

Faster drilling and lower drilling costs



Tapered drilling equipment offers a long list of advantages over integral steel. First and foremost, penetration is faster. Over 50% faster in some rock. Tapered bits are also easier to use: collaring is faster, drilling straight holes is simpler and vibrations are considerably lower. And in addition to all of this, tapered equipment actually gives you lower total drilling costs. Still not convinced? Do a test run and judge for yourself.

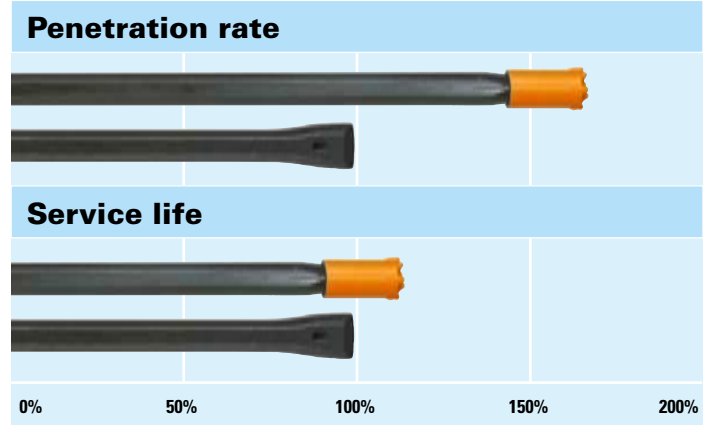

Optional equipment/spare

Pos.	Description	Part No
Compressed air hose for rock drill and feed, fitted with couplings for:		
1	BBC 16, BBC 34, BBD 46	9030 2051 00
2	RH 656	9030 2067 00
2	BBD 94	9030 2068 00
3	Water flushing hose with fitted couplings for BBC, BBD, RH	9030 2069 00
4	Lubricator for BBC, BBD, RH	
	BLG 30	8202 5102 05
	CLG 30	8202 5102 39
Tools for roof bolting with BBD 46WR		
5	Mandrel for 25 mm bolt	3081 0001 00
6	Socket for 37 mm hexagon nut	3081 0006 00

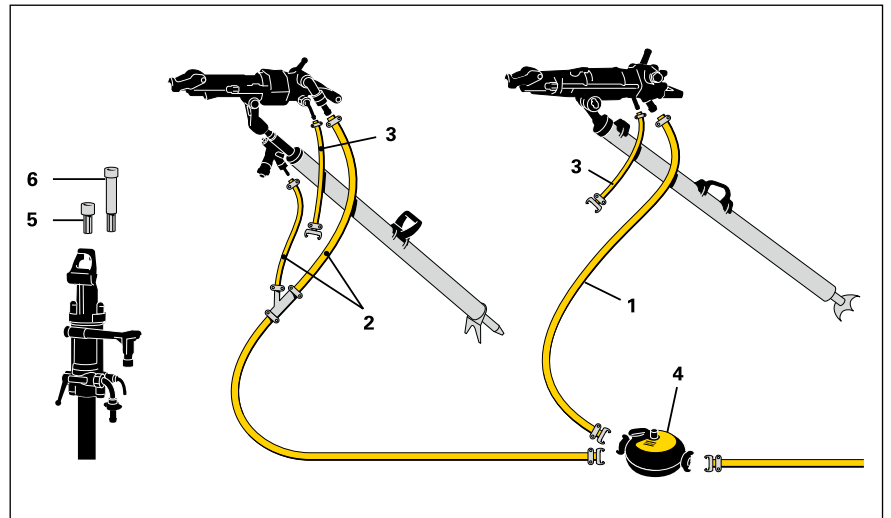

Use only authorized parts. Any damage or malfunction caused by the use of unauthorized parts is not covered by Warranty or Product Liability.